

Exhibit H

**Summary of Anticipated End State including photo-simulation of the
Site following the demolition**

Exhibit H

Summary of Anticipated End State

The attached Figures show the buildings and structures which will remain after the D&R project is complete. All buildings, structures, equipment, utilities, pavements and roads which are not required for on-going site operations will be decommissioned, demolished and removed or recycled. All regulated hazardous materials and wastes will be removed from building structures and equipment prior to demolition. All utilities (gas, electric, potable water, telecommunications, security systems, fire line water and sanitary sewer service), not required for the remaining buildings or on-going hydroelectric station or substation operations will be disconnected and properly abandoned or removed.

After demolition is complete, most of the disturbed areas will be covered with soil, seeded and restored to a grassy field or other vegetated state. While the attached figures show the MGP portion of the site as also vegetated, until that remediation is completed those portions of the MGP site which currently are covered by building foundations or other low permeable materials will retain their current condition. The final end state for this portion of the Beebee Flats will be determined during the MGP remedy selection. The gorge wall will be stabilized during removal of buildings and structures. Access roads and site drainage features will be restored as necessary.

As shown on the attached Figure, after the project is complete, the remaining above ground structures will include the security fencing with gates at the North and South ends of the site, security lighting, four smaller buildings at the north end of the site (Falls Street Buildings), the Station 137 substation, a phase shifter and the access road connecting to Station No. 2 Hydro Plant. A small parking area immediately adjacent to the north of property address 250 Mill Street and a gravel parking/access area adjacent to the south side of Station 137 also will remain. Existing electrical utilities and drainage utilities at the bottom of the gorge, also known as the “flats”, will remain. Old building foundations and underground trenches and ductwork that are more than 3 feet below the final design grade and the slabs and all subsurface features in the former MGP area will remain.

Long term site maintenance will include grass cutting, snow removal, inspection and necessary upkeep of stormwater drains/outfalls, fencing, lighting, gates and access roads maintenance.



NOTES:

1. CONTRACTOR TO INSTALL TEMPORARY SHORING AS NEEDED TO MAINTAIN SLOPE STABILITY. IF CONTRACTOR'S STRUCTURAL ENGINEER DETERMINES THAT PERMANENT SHORING IS WARRANTED, THE CONTRACTOR IS RESPONSIBLE TO HAVE STRUCTURAL ENGINEER DESIGN APPROPRIATE PERMANENT SHORING FOR CONSTRUCTION.
2. EXISTING WALLS THAT ARE TO REMAIN, CONTRACTOR SHALL REPAIR/STABILIZE WALL AS NEEDED TO MAINTAIN STRUCTURAL INTEGRITY AND PROVIDE UNIFORM SURFACE. TOP OF WALL TO BE CUT AND SMOOTH FINISH TO BE APPLIED.

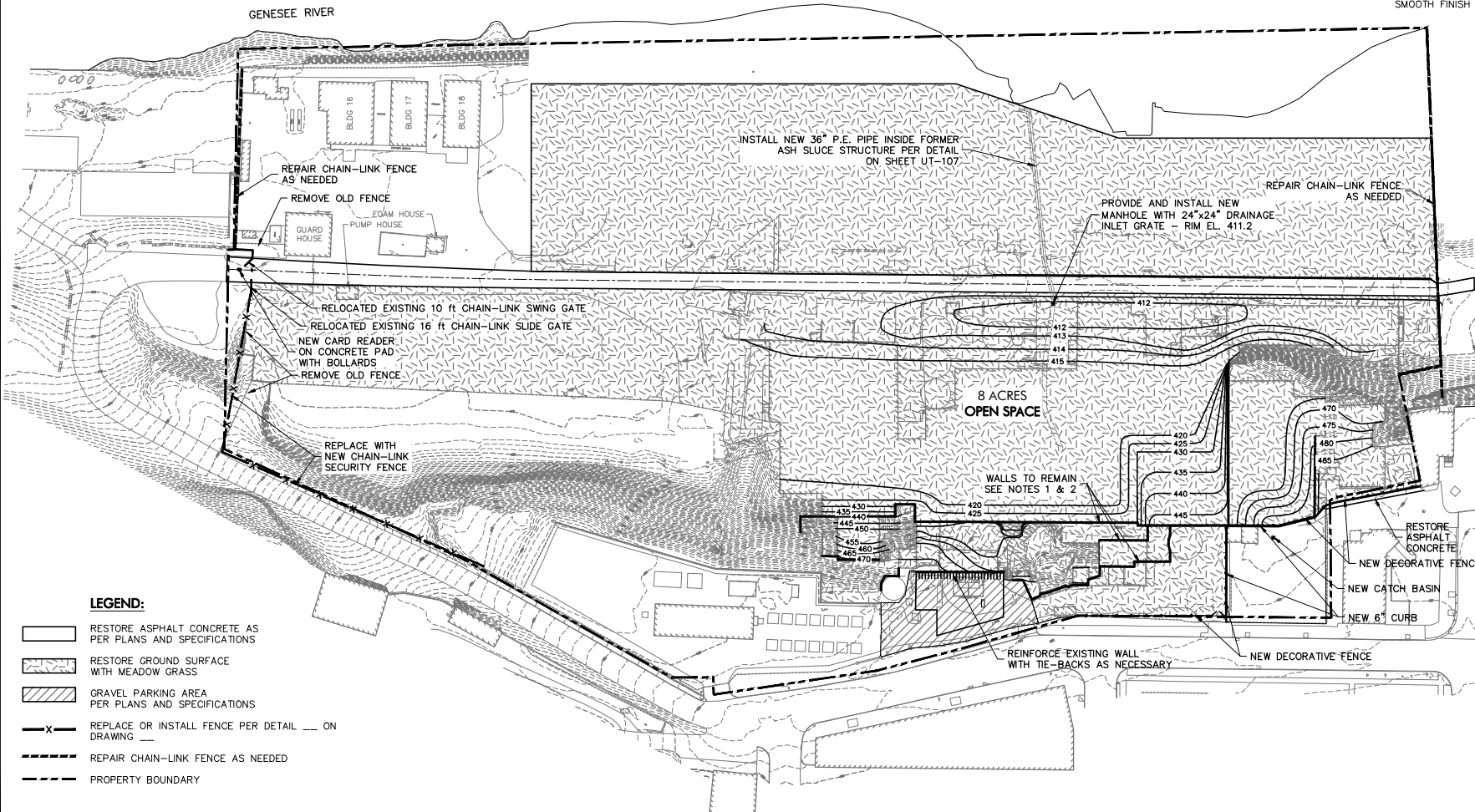

WARNING
IT IS A VIOLATION OF SECTION 2209, SUBDIVISION 2, OF THE NEW YORK STATE EDUCATION LAW FOR ANY PERSON OTHER THAN THOSE WHOSE SEAL APPEARS ON THIS DRAWING TO ALTER IN ANY WAY AN ITEM ON THIS DRAWING. IF AN ITEM IS ALTERED, THE ALTERING ENGINEER SHALL AFFIX TO THE ITEM HIS SEAL AND THE NOTATION "ALTERED BY" FOLLOWED BY HIS SIGNATURE AND THE DATE OF SUCH ALTERATION, AND A SPECIFIC DESCRIPTION OF THE ALTERATION.

NO.	DATE	DESCRIPTION
REVISIONS		



L&R Engineers, Inc.
250 Mill Street
Rochester, New York

PROJ. ENG.:
M.J.W.
DESIGNED BY:
J.R.P.
CHECKED BY:
R.F.K.
DRAWN BY:
A.M.K.

CLIENT:
 Rochester Gas & Electric
DATE: NOVEMBER 2013
SCALE: AS SHOWN

JOB TITLE AND LOCATION:
DEMOLITION AND REMEDIATION OF BEEBEE STATION
242 MILL STREET, ROCHESTER, NY 14614

DRAWING TITLE:
POST-DEMOLITION CONDITIONS

LRJ JOB NO.:
12-126-0881
SHEET
OF 11

FIGURE NO.:
2

